

DOMINO SILT TRAP

Features & Benefits

- Sturdy stainless steel construction.
- Convenient diagonally opposed lifting handles.
- Hydraulically designed to receive maximum flow.
- Screens silt, leaves, screws, butts etc.
- Protect against suction line blockage.
- Protect pumping equipment.
- Prevent pollution of waterways.

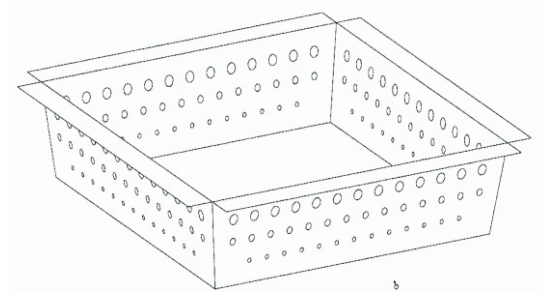

Silt Trap (Stainless Steel)
Part No: SILT600

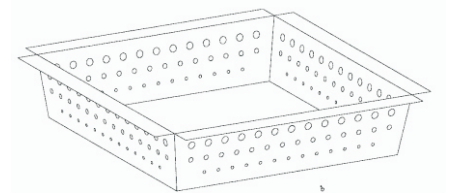

Silt Trap (Stainless Steel)
Part No: SILT450

Installation

When being used in trafficable areas, the EH600 collection pit must be installed with a concrete collar to fully support the top of the pit. This collar should be a minimum of 150 x 150mm around the top perimeter of the pit. A support brace is provided and when fixed as per instructions, will prevent deformation of the pit during back fill procedures. The support brace can be re-moved after installation is complete.



EH600 Collection Pit

Dimension

CODE	OVERALL	DEPTH	FLAP	THICKNESS
SILT600	660mm x 60mm	100mm	40mm	0.9
SILT450	510mm x 510mm	100mm	40mm	0.9

N.B. Other sizes available on application

Everything Water PTY LTD

VICTORIA

7 Ventnor Street, Balwyn North VIC 3104
+ Phone: +61 3 9857 9845 Fax: +61 3 9857 9445
+ Email: terryb@everythingwater.com

QUEENSLAND

Unit 3/32 Enterprise Street, Cleveland, QLD, 4163
+ Phone: +61 (7) 3821 6922 Fax: +61 7 3286 5077
+ Email: sales@everythingwater.com